

## 2. High Pressure Valve Plate Assembly - Model 2475

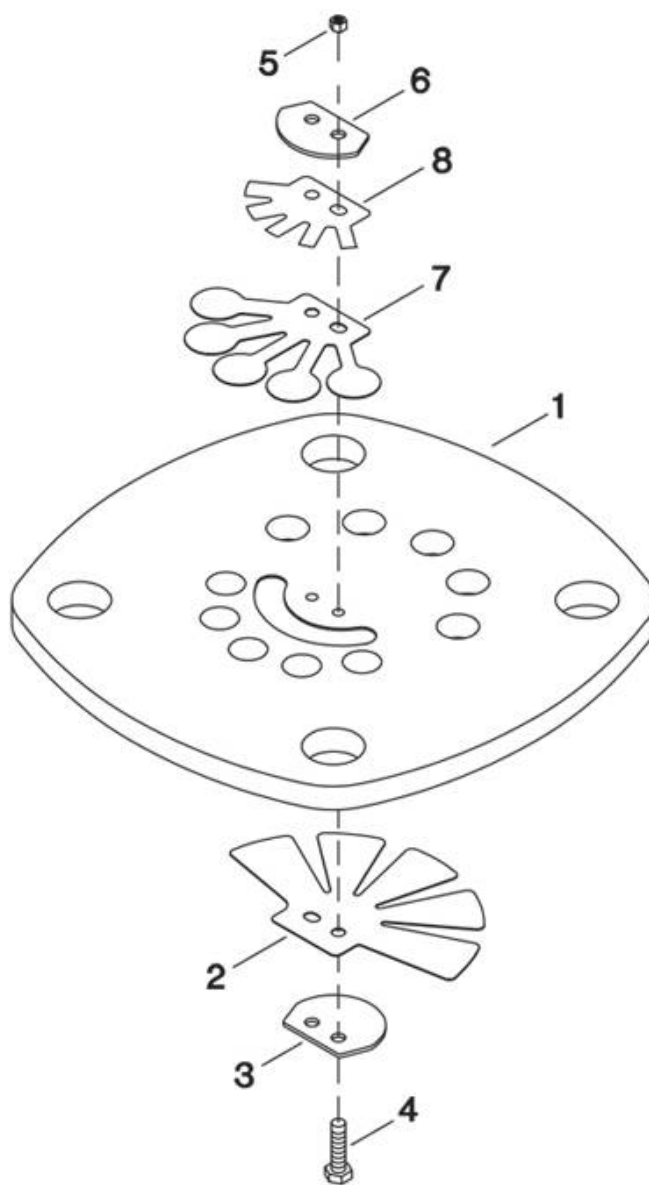

All manufacturer's names, numbers, photos, product description and/or part numbers are used for reference purposes only & it is not implied that any part listed is the product of these manufacturers. Since Approvement are made from time to time, the illustration and specifications are subject to change without notice.

## 2. High Pressure Valve Plate Assembly - Model 2475

REF. NO.	PART NO.	DESCRIPTION	QTY.	SPARES		
				1	2	3
REF.	32310799	ASSEMBLY, VALVE PLATE - HIGH PRESSURE	1		1	1
2-1	NSS	● PLATE, VALVE - HIGH PRESSURE	1			
2-2	32236671	● VALVE, FINGER - INLET	1	1	1	2
2-3	32297343	● RETAINER, VALVE HP	1			
2-4	32297327	● SCREW, HEX HEAD - M3 X 12	2			
2-5	97511059	● NUT, HEX - M3 WITH LOCKWASHER	2			
2-6	32295461	● RETAINER, FINGER VALVE - DISCHARGE	1			
2-7	32241010	● VALVE, FINGER - DISCHARGE	1	1	1	2
2-8	32295479	● VALVE, DAMPER - DISCHARGE	1			

All manufacturer's names, numbers, photos, product description and/or part numbers are used for reference purposes only & it is not implied that any part listed is the product of these manufacturers. Since Approvement are made from time to time, the illustration and specifications are subject to change without notice.